

Tunnel forms are room-size formwork elements that allow walls and floors to be casted in a single pour. With multiple forms, the entire floor of a building can be done in one go. Thanks to the daily work cycle, builders can produce up to 400m² of floor area every workday.

Tunnel form is mostly suitable for buildings that have the same or similar cells to allow re-use of the forms within the floor and from one floor to the next, such as prisons, apartments, hotels or mass housing projects.

PRODUCTIVITY ON SITE

- 25% time savings
- Simple and repetitive daily rotations
- Predictable production schedule
- Fast implementation of the tunnels

COST SAVINGS ON CONSTRUCTION

- 15 % cost savings
- High speed of construction
- Reduced need of skilled labour
- Minimal finishes to walls

QUALITY OF ACHIEVEMENTS

- Realization of monolithic structures resistant to earthquakes
- High dimensional accuracy
- Optimal concrete quality



SPECIFICATIONS

- Bay width: 2.4m to 6m.
Horizontal panel Type 1: 1.2m to 1.6m.
Type 2: 1.8m to 2.4m.
Type 3: 2.4m to 3m.
- Length of the packages: up to 12.5m depending on the crane capacity.
- Average weight of the shutter: 100kg/m².
- Designed for 6T/m² concrete pour pressure.

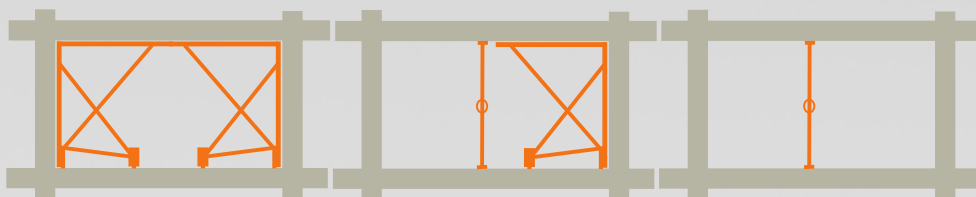
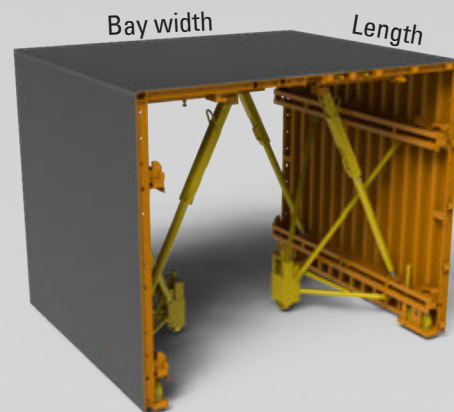

The stripping of the formwork is made half tunnel by half tunnel to constantly maintain the slab with props.

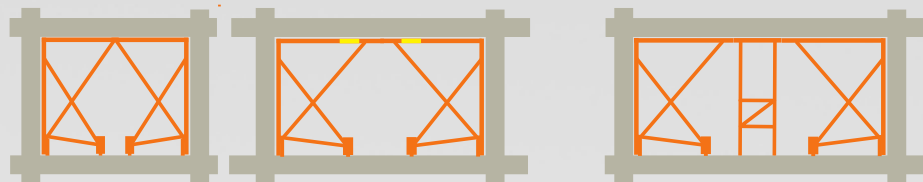

Many dimensions are possible with additional strips or table.

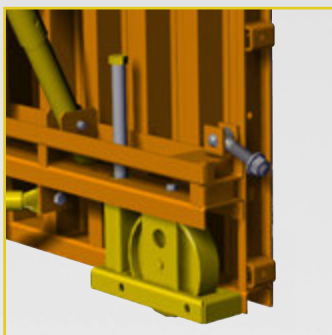

Wheels and levelling jack.

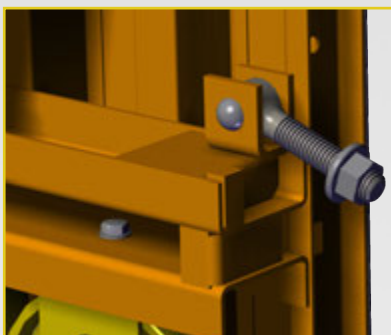

Horizontal coupling system.

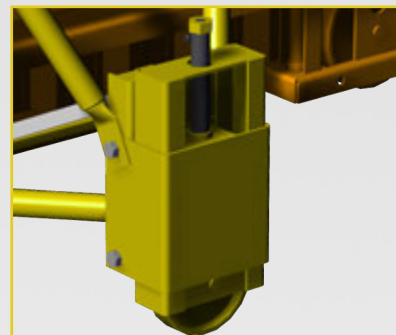

Triangulation wheel with levelling jack.

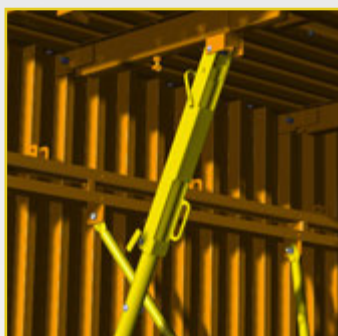

Strut system to ease the removal of the formwork.



Additional strip.

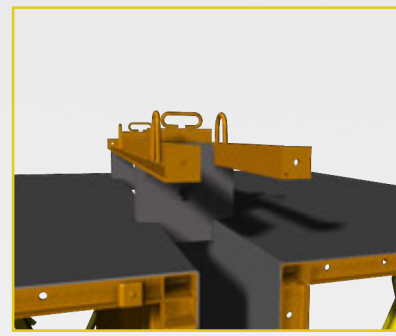

Kicker formwork for upper walls.